

Fulham Road, SW6

£500,000

BRIK





Fulham Road

£500,000 | 2 Bed | 600 | 55 | E | £15,000
LEASEHOLD | FLAT | SQ FT | SQ M | LBHF BAND | STAMP DUTY

Situated on the first floor of an attractive period building, this well-presented property comprises an open plan kitchen / reception room to the front, two double bedrooms to the rear and a modern bathroom. EPC: Band D

Located in the heart of Fulham and within an easy walk of the incredibly popular Parsons Green area and its underground station (District Line, Zone 2), there is a plethora of independent cafes, restaurants, and shops. Local bus routes have easy access to Fulham Broadway and towards Chelsea and central London.

- ✓ First floor conversion flat
- ✓ 2 Bedrooms
- ✓ Open plan reception room
- ✓ Modern bathroom
- ✓ Good decorative order
- ✓ 600 Sqft (55.74sqm)
- ✓ No onward chain
- ✓ Excellent location



Jessica Galletta

SALES ASSOCIATE
+8 YEARS EXPERIENCE

020 7384 6790

jess@brik.co.uk





FULHAM AREA GUIDE

Central Fulham North

This row of tree-lined streets, is home to a mix of family houses and ranks top of the list for sought-after Fulham locations.

There's a wide range of property here, from the beautiful semi-detached 'villas' on the East side of Lilyville Road, to the flats at the Northern end of Rostrevor Road and Radipole Road. In general the houses are slightly larger than those in Parsons Green (with the exception of the Lion houses in the Peterborough Estate) and can reach up to 3000 sq ft with basement.

Fulham Road itself is the focus of the action – with its independent cafes, restaurants and bus routes – but Parsons Green is also very nearby. Centrally located, large houses on tree-lined streets. Many have potential for extension into the basement with the added benefit of being close to Parsons Green station.

CLOSEST:

- 🚶 Parsons Green (7 mins)
- 🚶 West Brompton (26 mins)
- 🚶 Bishops Park (13 mins)

KEY:

- Property location
- 'Central Fulham North' area of Fulham

[Read all our Fulham area guides here](#)

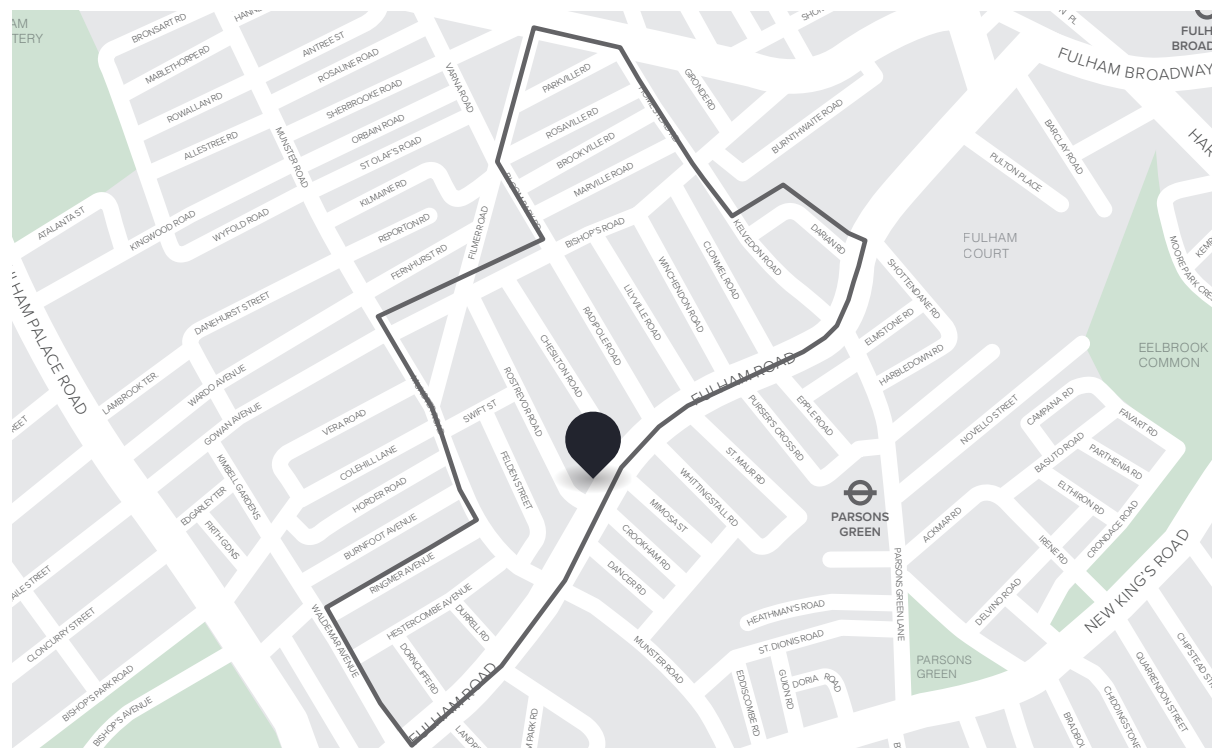

BRIK

600
SQ FT

55
SQ M

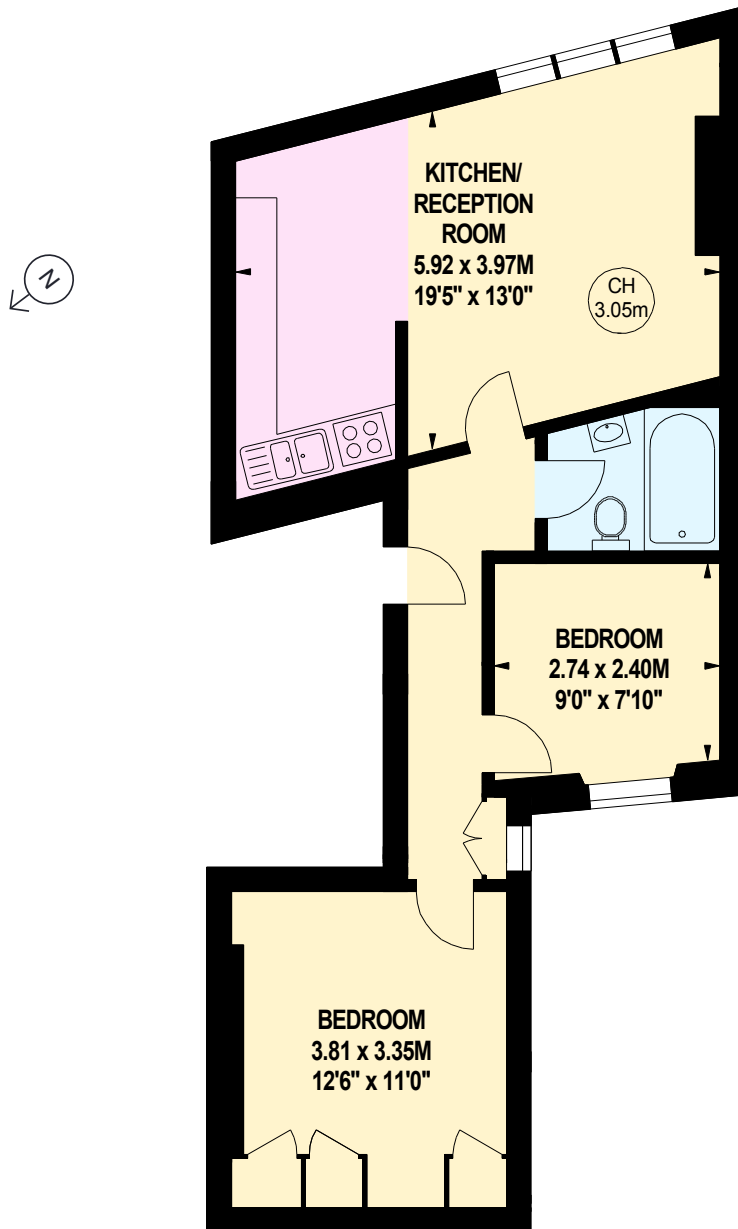

First Floor

Important notice Brik give notice that: all text, photographs and plans on these brochure are for guidance only and are not necessarily comprehensive; any areas, measurements or distances given are approximate; these details do not constitute part of an offer or contract and must not be relied upon as statements or representations of fact; it should not be assumed that the property has all the necessary planning permissions and building regulations approvals; we are not authorised to give any representations or warranties in relation to this property whatsoever; potential purchasers must satisfy themselves as to the correctness of all details by inspection or otherwise. Brik, 77 Parsons Green Lane, Fulham, London SW6 4JA Tel: 020 7384 6790 Email: hello@brik.co.uk